

PROPOSED DEVELOPMENT

5-9 Alexander Street, Fairy Meadow, NSW
greenview Job No: 230224

GENERAL NOTES

- ALL WORKS SHALL BE CARRIED OUT IN ACCORDANCE WITH THE NOMINATED OR APPLICABLE COUNCIL SPECIFICATION.
- THE CONTRACTOR SHOULD REPORT ANY DISCREPANCIES ON THE DRAWINGS TO THE ENGINEER RESPONSIBLE FOR THE DESIGN.
- IT IS THE RESPONSIBILITY OF THE TENDERER TO SEEK CLARIFICATION WHERE DOCUMENTATION IS CONFLICTING OR UNCLEAR. WHERE NO CLARITY IS OBTAINED, THE TENDERER IS TO ALLOW FOR BOTH INTERPRETATIONS IN THEIR PRICING.
- CONTRACTOR IS NOT TO ENTER UPON NOR DO ANY WORK WITHIN ADJACENT LANDS WITHOUT THE PERMISSION OF THE OWNER.
- SURPLUS EXCAVATED MATERIAL SHALL BE PLACED WHERE DIRECTED OR REMOVED FROM SITE.
- ALL NEW WORKS SHALL MAKE A SMOOTH JUNCTION WITH EXISTING.
- ALL DRAINAGE LINES THOUGH ADJACENT LOTS SHALL BE CONTAINED WITHIN EASEMENTS CONFORMING TO COUNCIL'S STANDARDS.
- PRIOR TO COMMENCEMENT OF WORK, THE CONTRACTOR SHALL PROVIDE A TRAFFIC MANAGEMENT PLAN PREPARED BY AN ACCREDITED PERSON IN ACCORDANCE WITH RMS REQUIREMENTS, FOR ANY WORK ON OR ADJACENT TO PUBLIC ROADS, PLAN TO BE SUBMITTED TO COUNCIL & RMS AS REQUIRED.
- THESE PLANS SHALL BE A READ-AND-JUNCTION WITH OTHER RELEVANT CONSULTANTS' PLANS, SPECIFICATIONS, CONDITIONS OF DEVELOPMENT CONSENT AND CONSTRUCTION CERTIFICATE REQUIREMENTS.
- THE BUILDING/CONTRACTOR SHALL LOCATE ALL EXISTING PUBLIC UTILITY SERVICES WITHIN THE SITE, FOOTPATH AREA AND ROAD RESERVE PRIOR TO THE COMMENCEMENT OF ANY WORKS. ALL LOCATIONS AND LEVELS OF SERVICES SHALL BE REPORTED TO THE STORMWATER ENGINEER PRIOR TO THE COMMENCEMENT OF ANY WORKS TO ENSURE THERE ARE NO OBSTRUCTIONS IN THE LINE OF THE DRAINAGE DISCHARGE PIPES.
- THE BUILDER IS TO VERIFY ALL LEVELS ON SITE PRIOR TO COMMENCING CONSTRUCTION.
- ALL THE CLEANING EYES (OR INSPECTION EYES) FOR THE UNDERGROUND PIPES HAVE TO BE TAKEN UP TO THE FINISHED GROUND LEVEL FOR EASY IDENTIFICATION AND MAINTENANCE PURPOSES.
- ALL TERRACE FLOOR AND PLANTER GRATES TO HAVE FIRE COLLARS FITTED EXCEPT FOR CLASS 1 BUILDINGS.
- ALL PITS HAVING AN INTERNAL DEPTH THAT EXCEEDS 1.0m SHALL BE PROVIDED WITH GALVANIZED STEP IRONS AT 300 mm CENTRES PLACED IN A STAGGERED PATTERN AND SHALL BE IN ACCORDANCE WITH THE AUSTRALIAN STANDARDS AS1198-1994.
- ALL MULCHING TO BE USED WITHIN THE AREA DESIGNATED AS ON SITE DETENTION STORAGE SHALL BE OF A NON-FLOATABLE MATERIAL SUCH AS AGGREGATE GRAVEL OR DARK MULCHING SHALL NOT BE USED WITHIN THE DETENTION STORAGE AREA.
- PRIOR TO COMMENCING ANY WORKS ON THE SITE, THE BUILDER SHALL ENSURE THAT THE INVERT LEVELS OF WHERE THE SITE STORMWATER SYSTEM CONNECTION INTO COUNCILS KERBSIDE DRAINAGE SYSTEM MATCH THE DESIGN LEVELS. ANY DISCREPANCIES SHALL BE REPORTED TO THE DESIGN ENGINEER IMMEDIATELY.
- GREENVIEW IS NOT RESPONSIBLE FOR THE ACCURACY OF ANY SURVEY INFORMATION PROVIDED ON THIS DRAWING.
- ALL LEVELS SHOWN ARE EXPECTED TO BE TO A H.D.
- ALL CHAINAGES AND LEVELS ARE IN METRES, AND DIMENSIONS IN MILLIMETRES, UNLESS NOTED OTHERWISE.
- THE SURVEY INFORMATION ON THIS DRAWING HAS BEEN PROVIDED BY THE ARCHITECT.
- CONTRACTORS SHALL ARRANGE FOR THE WORKS TO BE SET OUT BY A REGISTERED SURVEYOR.
- W A E DRAWINGS BY A REGISTERED SURVEYOR ARE REQUIRED PRIOR TO CERTIFICATION OF DRAINAGE.
- WHERE THESE PLANS ARE NOTED FOR DEVELOPMENT APPLICATION PURPOSES ONLY, THEY SHALL NOT BE USED FOR OBTAINING A CONSTRUCTION CERTIFICATE NOR USED FOR CONSTRUCTION PURPOSES WITHOUT WRITTEN APPROVAL.
- WATER TREATMENT DEVICES TO STRICTLY COMPLY WITH MANUFACTURING SPECIFICATIONS.

RAINWATER REUSE SYSTEM NOTES

- RAINWATER SUPPLY PUMPING TO BE CONNECTED TO OUTLETS WHERE REQUIRED BY BASIX CERTIFICATE (BY OTHERS).
- NO DIRECT CONNECTION BETWEEN TOWN WATER SUPPLY AND THE RAINWATER SUPPLY.
- PROVIDE AN APPROVED STOP VALVE AND/OR PRESSURE LIMITING VALVE AT THE RAINWATER TANK.
- PROVIDE AT LEAST ONE EXTERNAL HOSE COCK ON THE TOWN WATER SUPPLY FOR FIRE FIGHTING.
- PROVIDE APPROPRIATE FLOAT VALVE AND/OR SOLENOID VALVES TO CONTROL TOWN WATER SUPPLY INLET TO TANK IN ORDER TO ACHIEVE THE TOP-UP INDICATED ON THE TYPICAL DETAIL.
- ALL PLUMBING WORKS ARE TO BE CARRIED OUT BY LICENSED PLUMBERS IN ACCORDANCE WITH AS/NZS3500.1 NATIONAL PLUMBING AND DRAINAGE CODE.
- PRESSURE PUMP ELECTRICAL CONNECTION TO BE CARRIED OUT BY A LICENSED ELECTRICIAN.
- ONLY ROOF RUN-OFF IS TO BE DIRECTED TO THE RAINWATER TANK SURFACE WATER INLETS ARE NOT TO BE CONNECTED.
- PIPE MATERIALS FOR RAINWATER SUPPLY PUMPING ARE TO BE APPROVED MATERIALS TO AS/NZ3500 PART 1 SECTION 2 AND TO BE CLEARLY AND PERMANENTLY IDENTIFIED AS RAINWATER. THIS MAY BE ACHIEVED FOR BELOW GROUND PIPES USING IDENTIFICATION TAPE (MADE IN ACCORDANCE WITH AS2648) OR FOR ABOVE GROUND PIPES BY USING ADHESIVE PIPE MARKERS (MADE IN ACCORDANCE WITH AS1345).
- EVERY RAINWATER SUPPLY OUTLET POINT AND THE RAINWATER TANK ARE TO BE LABELLED 'RAINWATER' ON A METALLIC SIGN IN ACCORDANCE WITH AS1319.
- ALL INLETS AND OUTLETS TO THE RAINWATER TANK ARE TO HAVE SUITABLE MEASURES PROVIDED TO PREVENT MOSQUITO AND VERMIN ENTRY.
- ALL DOWNPIPES CHARGED TO THE RAINWATER TANK ARE TO BE SEALED UP TO GUTTER LEVEL AND BE PRESSURE TESTED AND CERTIFIED.
- TOWN WATER CONNECTION TO RAINWATER TANK TO BE TO THE SATISFACTION OF THE REGULATORY AUTHORITY. THIS MAY REQUIRE PROVISION OF

- 13.1. PERMANENT AIR GAP
- 13.2. BACKFLOW PREVENTION DEVICE

SAFETY IN DESIGN NOTES

THERE ARE INHERENT RISKS WITH CONSTRUCTING, MAINTAINING, OPERATING, DEMOLISHING, DISMANTLING AND DISPOSING. WE NOTE THIS DESIGN IS TYPICAL OF SIMILAR DESIGNS. AS FAR AS IS REASONABLY PRACTICABLE RISKS HAVE BEEN ELIMINATED OR MINIMISED THROUGH THE DESIGN PROCESS. HAZARD CONTROLS MUST STILL BE IMPLEMENTED BY THE CONTRACTOR, OWNER OR OPERATOR TO ENSURE THE SAFETY OF WORKERS. GREENVIEW ASSESSMENT DID NOT IDENTIFY ANY UNIQUE RISKS ASSOCIATED WITH THE DESIGN.

EARTHWORK NOTES

- IT IS THE CONTRACTORS RESPONSIBILITY TO LOCATE AND LEVEL ALL EXISTING SERVICES PRIOR TO THE COMMENCEMENT OF ANY EARTHWORKS.
- THE CONTRACTOR SHALL CLEAR THE SITE BY REMOVING ALL RUBBISH, FENCES AND DEBRIS ETC. TO THE EXTENT OF THE PROPOSED DEVELOPED AREA.
- PROVIDE PROTECTION BARRIERS TO PROTECTED/SENSITIVE AREAS PRIOR TO ANY BULK EXCAVATION.
- OVER FULL AREA OF EARTHWORKS, CLEAR VEGETATION, RUBBISH, SLABS ETC. AND STRIP TOP SOIL, AVERAGE 200mm THICK. REMOVE FROM SITE, EXCEPT TOP SOIL FOR RE-USE.
- CUT AND FILL OVER THE SITE TO LEVELS REQUIRED.
- PRIOR TO ANY FILLING IN AREAS OF CUT OR IN EXISTING GROUND, PROOF ROLL THE EXPOSED SURFACE WITH A ROLLER OF MINIMUM WEIGHT OF 5 TONNES WITH A MINIMUM OF 10 PASSES.
- EXCAVATE AND REMOVE ANY SOFT SPOTS ENCOUNTERED DURING PROOF ROLLING AND REPLACE WITH APPROVED FILL COMPACTED IN LAYERS. THE WHOLE OF THE EXPOSED SUBGRADE AND FILL SHALL BE COMPACTED TO 98% STANDARD MAXIMUM DRY DENSITY AT OPTIMUM MOISTURE CONTENT.
- FOR ON SITE FILLING AREAS, THE CONTRACTOR SHALL TAKE LEVELS OF EXISTING SURFACE AFTER STRIPPING TOPSOIL AND PRIOR TO COMMENCING FILL OPERATIONS.
- WHERE HARD ROCK IS EXPOSED IN THE EXCAVATED SUB-GRADE, THIS WILL BE INSPECTED AND A DECISION MADE ON THE LEVEL TO WHICH EXCAVATION IS TAKEN.
- FILL IN 200mm MAXIMUM (LOOSE THICKNESS) LAYERS TO UNDERSIDE OF BASECOURSE USING THE EXCAVATED MATERIAL AND COMPACTED TO 98% STANDARD (AS 1289 5.1.1). MAXIMUM DRY DENSITY AT OPTIMUM MOISTURE CONTENT $\pm 2\%$ SHOULD THERE BE INSUFFICIENT MATERIAL FROM SITE EXCAVATIONS, IMPORT AS NECESSARY CLEAN GRANULAR FILL TO APPROVAL.
- COMPACTION TESTING SHALL BE CARRIED OUT AT THE RATE OF 2 TESTS PER 1000SQ METRES PRIOR TO THE COMMENCEMENT OF LABORATORY. THE COSTS OF TESTING AND RE-TESTING ARE TO BE ALLOWED FOR BY THE BUILDER.
- BATTERS TO BE AS SHOWN, OR MAXIMUM 1 VERT : 4 HORIZ.
- ALL CONDUITS AND MAINS SHALL BE LAID PRIOR TO LAYING FINAL PAVEMENT.
- ALL BATTERS AND FOOTPATHS ADJACENT TO ROADS SHALL BE TOP SOILED WITH 150mm OF IMPROVED LOAM AND SEEDED UNLESS OTHERWISE SPECIFIED.

DRAINAGE INSTALLATION

RCP CONVENTIONAL INSTALLATIONS & ROAD CROSSINGS

- SUPPLY & INSTALLATION OF DRAINAGE WORKS TO BE IN ACCORDANCE WITH THESE DRAWINGS, THE COUNCIL SPECIFICATION AND THE CURRENT APPLICABLE AUSTRALIAN STANDARDS.
- BACKFILL SHALL BE PLACED & COMPACTED IN ACCORDANCE WITH THE SPECIFICATION: A GRANULAR GRAVEL AGGREGATE MATERIAL (<10mm) BACKFILL IS RECOMMENDED FOR THE BEDDING, HAUNCH SUPPORT AND SIDE ZONE DUE TO ITS SELF COMPACTING ABILITY.
- A MINIMUM OF 150mm CLEARANCE IS TO BE PROVIDED BETWEEN THE OUTSIDE OF THE PIPE BARRIERS AND THE TRENCH WALL FOR PIPES < 600 DIA. 200mm CLEARANCE FOR PIPES 600 TO 1200 DIA. AND 400 CLEARANCE FOR PIPES > 1200 DIA.
- BEDDING OF THE PIPELINES IS TO BE TYPE 'HS2' IN ACCORDANCE WITH THE STANDARDS AND AS FOLLOWS:

a. COMPACTED GRANULAR MATERIAL IS TO COMPLY WITH THE FOLLOWING GRADINGS:						
M	19	2.3600	0.6000	0.3000	0.1500	0.0750
% MASS PASSING	100	50-100	20-90	10-60	0-25	0-10

-AND THE MATERIAL PASSING THE 0.075 SIEVE HAVING LOW PLASTICITY 'AS DESCRIBED IN APPENDIX D OF AS1726.

b. BEDDING DEPTH UNDER THE PIPE TO BE 100mm.

c. BEDDING MATERIAL TO BE EXTENDED FROM THE TOP OF THE BEDDING ZONE UP TO 0.3 TIMES PIPE OUTSIDE DIAMETER. THIS REPRESENTS THE 'HAUNCH ZONE.'

d. THE BEDDING & HAUNCH ZONE MATERIAL IS TO BE COMPACTED TO A MINIMUM RELATIVE COMPACTION OF 98% WITHIN ROAD RESERVES AND TRAFFICABLE AREAS AND 95% ELSEWHERE FOR COHESIVE MATERIAL OR A MINIMUM DENSITY INDEX OF 70% IN ACCORDANCE WITH THE STANDARDS FOR COHESIONLESS MATERIAL.

e. COMPACTION TESTING SHALL BE CARRIED OUT BY AN APPROVED ORGANISATION WITH A NATA CERTIFIED LABORATORY FOR ALL DRAINAGE LINES LAID WHOLLY OR IN PART UNDER THE KERB & GUTTER OR PAVEMENT.

ROOF DRAINAGE

- ALL ROOF DRAINAGE IS TO BE DESIGNED AND INSTALLED IN ACCORDANCE WITH THE CURRENT APPLICABLE AUSTRALIAN STANDARDS INCLUDING AS3500.3, NCC AND COUNCIL'S SPECIFICATIONS.
- DOWNPIPES SHOWN ARE INDICATIVE ONLY. REFER ARCHITECTURAL'S FOR FINAL LOCATIONS.
- ALL DOWNPIPES TO BE CONSTRUCTED OF ONE MATERIAL FOR AESTHETICS REASONS AND PAINTED TO PROTECT THEM AGAINST ULTRA-VIOLET LIGHT DAMAGE, UNLESS APPROVED OTHERWISE BY THE PROJECT ARCHITECT.
- ALL DOWNPIPES TO HAVE LEAF GUARDS.
- ALL EAVES GUTTERS ARE TO BE DESIGNED TO THE 5% AEP (20YR) STORM EVENTS UNO.
- ALL EAVES' GUTTER OVERFLOWS ARE TO BE IN ACCORDANCE WITH AS3500.3 G3.
- ALL BOX GUTTERS ARE TO BE DESIGNED TO CATER TO THE 1% AEP (100YR) STORM EVENTS UNO.
- IN ACCORDANCE WITH AS3500.3 CLAUSE 3.7.6 G, BOX GUTTERS SHALL:
 - BE STRAIGHT (WITHOUT CHANGE IN DIRECTION)
 - HAVE A HORIZONTAL CONSTANT WIDTH BASE (SOLE) WITH VERTICAL SIDES IN A CROSS-SECTION.
 - HAVE A CONSTANT LONGITUDINAL SLOPE BETWEEN 1:200 AND 1:40.
 - DISCHARGE AT THE DOWNSTREAM END WITHOUT CHANGE OF DIRECTION (I.E. NOT TO THE SIDE). AND
 - BE SEALED TO THE RAINHEADS AND SUMPS
- GREENVIEW RECOMMENDS THAT THE BUILDER VERIFIES THAT ANY AND ALL BOX GUTTERS HAVE BEEN DESIGNED BY A QUALIFIED CIVIL ENGINEER PRIOR TO THE COMMENCEMENT OF WORKS.
- GREENVIEW RECOMMENDS A SPECIFIC INSPECTION AND CERTIFICATION BY A QUALIFIED CIVIL ENGINEER OF ANY AND ALL BOX GUTTERS INSTALLED ON THE PROJECT PRIOR TO OCCUPATION CERTIFICATE.
- ALL DOWNPIPES ARE TO BE PIPE CONNECTED INTO THE FORMAL RAINWATER OR STORMWATER LINE UNLESS SPECIFICALLY NOTED ON THE DRAWINGS OTHERWISE.

STORMWATER DRAINAGE NOTES

- STORMWATER DRAINAGE SHALL BE GENERALLY IN ACCORDANCE WITH CURRENT AUSTRALIAN STANDARDS INCLUDING AS3500.3, NCC AND COUNCIL'S SPECIFICATION.
- MINIMUM PIT DIMENSIONS ARE TO BE IN ACCORDANCE WITH AS3500.3 TABLE 7.5.2.1 WHICH PROVIDES GUIDANCE ACCORDING TO PIT DEPTH U.N.O.

TABLE 7.5.2.1

Minimum internal dimensions			
Depth to invert of outlet	mm		
	Rectangular	Circular	
	Width	Length	Diameter
≤450	350	350	—
≤600	450	450	600
>600 ≤900	600	600	900
>900 ≤1200	600	900	1000
>1200	900	900	1000

- PIPES OF 225mm DIA. AND UNDER SHALL BE UPVC
- PIPES OF 300mm DIA. AND LARGER SHALL BE FRC OR CONCRETE CLASS 2 RUBBER RING JOINTED UNO.
- ALL FRC OR RCP STORMWATER PIPES WITHIN ROAD RESERVE AREAS TO BE CLASS 3 U.N.O. BY COUNCIL'S SPECIFICATION.
- PIPES SHALL GENERALLY BE LAID AT THE GRADES INDICATED ON THE DRAWINGS.
- MINIMUM COVER TO PIPES 300mm DIA. AND OVER GENERALLY SHALL BE 600mm IN CARPARK & ROADWAY AREAS UNO.
- ALL PIPES LOCATED IN LANDSCAPE AREAS TO HAVE 300mm COVER, WHERE NOT POSSIBLE AND COVER IS BETWEEN 150mm AND 300mm USE SEWER GRADE PIPE.
- PIPES 225mm DIA AND OVER SHALL BE LAID AT 0.5% MIN. GRADE U.N.O.
- PIPES UP TO 150mm DIA SHALL BE LAID AT 1.0% MIN. GRADE U.N.O.
- BACKFILL TRENCHES WITH APPROVED FILL COMPACTED IN 200mm LAYERS TO 98% OF STANDARD DENSITY.
- ANY PIPES OVER 16% GRADE SHALL HAVE CONCRETE BULKHEADS AT ALL JOINTS.
- THE MINIMUM SIZES OF THE STORMWATER DRAINAGE PIPES SHALL NOT BE LESS THAN 90mm DIA FOR CLASS 1 BUILDINGS AND 100mm DIA FOR OTHER CLASSES OF BUILDING OR AS REQUIRED BY THE REGULATORY AUTHORITY.
- BUILD INTO UPSTREAM FACE OF ALL PITS A 3.0m SUBSOIL LINE FALLING TO PITS TO MATCH PIT INVERTS.
- ALL LANDSCAPED PITS TO BE MIN 450 SQUARE U.N.O OR LARGER AS REQUIRED BY AS3500.3 TABLE 7.5.2.1
- GREENVIEW RECOMMENDS ALL COURTYARDS TO HAVE 450 SQUARE PLASTIC PIT INSTALLED WITH A 150mm DIA. CONNECTION TO FORMAL DRAINAGE SYSTEM U.N.O.
- ALL DRIVEWAY PITS TO BE MIN 600 SQUARE U.N.O OR LARGER AS REQUIRED BY AS3500.3 TABLE 7.5.2.1
- ALL PLANTER BOXES AND BALCONIES TO BE CONNECTED TO THE PROPOSED STORMWATER DRAINAGE LINE.
- ALL STORMWATER DRAINAGE WORK TO AVOID TREE ROOTS, WHERE NOT POSSIBLE, ALL EXCAVATIONS IN VICINITY OF TREE ROOTS ARE TO BE HAND DUG.
- GEOTEXTILE FABRIC TO BE PLACED UNDER RIP RAP SCOUR PROTECTION WHERE APPLICABLE.
- ALL BASES OF PITS TO BE BENCHED (TO HALF PIPE DEPTH) TO THE INVERT OF THE OUTLET PIPE AND PROVIDE GALVANISED ANGLE SURROUNDINGS TO CONSTRUCTION PURPOSES WITHOUT WRITTEN APPROVAL.

- ANY VARIATION TO THAT WORKS AS SHOWN ON THE APPROVED DRAWINGS ARE TO BE CONFIRMED BY THE ENGINEER PRIOR TO THE COMMENCEMENT.
- ALL BALCONIES AND ROOFS TO BE DRAINED AND TO HAVE SAFETY OVERFLOWS IN ACCORDANCE WITH RELEVANT AUSTRALIAN STANDARDS.
- GREENVIEW RECOMMENDS ALL ACCESSIBLE GRATES TO BE FITTED WITH CHILD-PROOF LOCKS.
- ALL WORK WITHIN COUNCIL RESERVE AREAS TO BE INSPECTED BY COUNCIL PRIOR TO BACKFILLING.
- COUNCIL'S ISSUED FOOTWAY DESIGN LEVELS TO BE INCORPORATED INTO THE FINISHED LEVELS ONCE ISSUED BY COUNCIL.
- WATER PROOF ALL CONCRETE BALCONIES & ROOFS TO ARCHITECTS DETAILS
- ALL BALCONIES TO HAVE FLOOR WASTE AND 1% FALL WITH SAFETY OVERFLOW.
- ALL SUBSOIL DRAINAGE SHALL BE A MINIMUM OF Ø95mm AND SHALL BE PROVIDED WITH A FILTER SOCK. THE SUBSOIL DRAINAGE SHALL BE INSTALLED IN ACCORDANCE WITH DETAILS TO BE PROVIDED BY THE LANDSCAPE CONSULTANT.
- SUBSOIL DRAINAGE PIPES AND FITTINGS SHALL BE PERFORATED PLASTIC TO CURRENT AUSTRALIAN STANDARDS. LAY PIPES ON FLOOR OF TRENCH GRADED AT 1% MIN. AND OVERLAY WITH FILTER MATERIAL EXTENDING TO WITHIN 200mm OF SURFACE. PROVIDE FILTER FABRIC OF PERMEABLE POLYPROPYLENE BETWEEN FILTER MATERIAL AND TOPSOIL. PROVIDE FLUSHING EYES AT HIGH POINTS OR TO COUNCILS REQUIREMENTS.
- ALL GRATES IN AREAS OF FREQUENT PEDESTRIAN TRAFFIC (IE FOOTPATHS, WALKWAYS, ETC.) TO BE IRON OR STEEL GRATES.
- REFER ARCHITECT'S DETAIL FOR GRATE FINISH (IE STAINLESS STEEL OR GALVANISED).
- GRATES TO BE IN ACCORDANCE WITH TABLE BELOW:

PIT GRATE INLINE TYPE

GRATE TYPE	TRAFFIC CONDITIONS
A - EXTRA LIGHT DUTY	FOOTPATHS AND AREAS ACCESSIBLE ONLY TO PEDESTRIANS AND REAR CYCLISTS.
B - LIGHT DUTY	FOOTPATHS THAT CAN BE MOUNTED BY VEHICLES.
C - MEDIUM DUTY	MALLS AND PEDESTRIAN AREAS OPEN TO SLOW MOVING COMMERCIAL VEHICLES.
D - HEAVY DUTY	CARRIAGEWAYS OF ROADS AND AREAS OPEN TO COMMERCIAL VEHICLES.

TABLE AS PER AS3500.3 - 2008. ENGINEER TO BE NOTIFIED IF LOAD CONDITIONS LISTED ABOVE ARE EXCEEDED.

- COVER TO PIPE TO BE AS PER TABLE BELOW:

COVER TABLE

LOCATION	PIPE TYPE	COVER
LANDSCAPE	PVC	300
LANDSCAPE (SINGLE DWELLING)	PVC	100
UNDER TRAFFICABLE AREA	PVC	100 BELOW UNDERSIDE OF PAVEMENT
CONCRETE	STEEL	NIL BELOW UNDERSIDE OF PAVEMENT
ROADS	RCP	500 BELOW UNDERSIDE OF PAVEMENT

STORMWATER DRAINAGE NOTES CONTINUED

- GREENVIEW'S STORMWATER SYSTEM HAS BEEN DESIGNED TO CAPTURE SURFACE RUNOFF FROM THE SITE ITSELF BUT DOES NOT INCORPORATE SPECIFIC GROUNDWATER CAPTURE MECHANISMS. IN SOME CASES, GROUNDWATER INUNDATION MAY BE A SIGNIFICANT SOURCE OF WATER DURING A STORM EVENT. GREENVIEW RECOMMENDS THAT A RETAINING WALL IS CLOSE TO HABITABLE AREAS BE FITTED WITH AN IMPERMEABLE MEMBRANE AND SUBSOIL DRAINAGE TO PREVENT GROUNDWATER INGRESS.
- IF AN AREA OF GROUNDWATER IS ENCOUNTERED DURING WORKS, WHERE 300mm COVER IS NOT ACHIEVED, NOTIFY ENGINEER.
- WHERE STORMWATER DRAINAGE WORKS ARE TO BE UNDERTAKEN PRIOR TO THE CONSTRUCTION OF THE BUILDING, THE BUILDER IS TO SET OUT THE FLOOR LEVELS AND ENSURE PROPOSED STORMWATER DRAINAGE LEVELS AND BUILDING LEVELS ARE COMPATIBLE. NOTIFY ENGINEER IMMEDIATELY IF ANY DISCREPANCIES.

ON-SITE DETENTION

- ON-SITE DETENTION (OSD) TANKS ARE TO BE DESIGNED AND INSTALLED IN ACCORDANCE WITH THE CURRENT APPLICABLE AUSTRALIAN STANDARDS INCLUDING AS3500.3, NCC AND COUNCIL'S SPECIFICATIONS.
- IT IS CRITICAL THAT THE MINIMUM OSD VOLUME AS CALCULATED BY THE DESIGN AND NOTED ON THESE PLANS IS ACHIEVED ON SITE. VOLUMES TO BE VERIFIED BE REGISTERED SURVEYOR AND NOTED IN THE WAE SURVEY PRIOR TO CERTIFICATION.
- OSD VOLUME MAY BE ACHIEVED IN BELOW GROUND TANK, OR ABOVE GROUND PONDING, OR RAINWATER TANK OFFSET, OR INFILTRATION/ABSORPTION SYSTEM. EACH COUNCIL HAS SPECIFIC GUIDELINES FOR HOW STORMWATER FLOWS ARE TO BE CONTROLLED AND DISCHARGED.
- PONDING AND OVERFLOW LEVELS FROM THE OSD SHALL BE NOT LESS THAN 300mm BELOW ADJACENT HABITABLE FLOOR LEVELS OF BUILDINGS AND NOT LESS THAN 150mm BELOW NON-HABITABLE FLOOR LEVELS (AS3500.1 CLAUSE 7.10.1).

BELOW GROUND OSD TANKS

- THE HYDRAULIC CONTROL FOR THE STORAGE (USUALLY ORIFICE PLATE) SHALL BE FIRMLY FIXED IN PLACE TO PREVENT REMOVAL OR TAMPERING. A PLATE OF 3mm TO 5mm THICK STAINLESS STEEL WITH A CIRCULAR HOLE SHALL BE USED, PROVIDED:
 - IT IS MACHINED TO 0.5mm ACCURACY
 - IT RETAINS A SHARP EDGE, AND
 - THE ORIFICE DIAMETER IS NOT LESS THAN 25mm (AS 3500.3 CLAUSE 7.10.2
- INSPECTION / ACCESS OPENINGS SHALL BE PROVIDED ABOVE THE LOCATION OF THE OUTLET WITH DIMENSIONS AT LEAST 600mm x 600mm OR 600mm DIAMETER FOR STORAGE'S UP TO 600mm DEEP AND 600mm x 900mm FOR DEEPER STORAGE'S. THERE SHALL BE NO IMPEDIMENTS TO THE REMOVAL OF DEBRIS THROUGH THIS OPENING. INSPECTION SHALL BE POSSIBLE WITHOUT RESIDENTS OR OWNERS HAVING TO REMOVE HEAVY ACCESS COVERS (AS3500.3 CLAUSE 7.10.2.b.i)
- WHERE STORAGE'S ARE NOT DEEP ENOUGH TO WORK IN (<1.5m DEEP), ACCESS SHALL BE PROVIDED AT INTERVALS OF APPROXIMATELY 10m TO ALLOW THE SYSTEM TO BE FLUSHED TO THE STORAGE OUTLET- ACCESS SHALL BE PROVIDED AT THE OUTLET (AS3500.3 CLAUSE 7.10.2.b.ii)
- A SUMP SHALL BE PROVIDED AT THE OUTLET POINT, SET BELOW THE LEVEL OF THE MAIN STORAGE TO COLLECT DEBRIS, WHERE A DISCHARGE CONTROL PIT IS INCLUDED IN THE STORAGE- THIS SHALL CONTAIN A SUMP SET A MINIMUM OF 1.5 TIMES THE DIAMETER OF THE ORIFICE OF THE OUTLET BELOW THE CENTRE OF THE ORIFICE. SUMPS SHALL BE PROVIDED WITH WEEP HOLES TO DRAIN OUT TO THE SURROUNDING SOIL, AND SHALL BE FOUNDED ON A COMPACTED GRANULAR BASE.
- WHERE THE DEPTH OF THE TANK EXCEEDS 1.2m, A LADDER IN ACCORDANCE WITH AS3500.3 CLAUSE 7.5.4 SHALL BE INSTALLED.
- BELOW GROUND OSD SYSTEMS SHALL CONFORM WITH AS2865.
- IN ACCORDANCE WITH AS3500.3 CLAUSE 7.10.2.0 SCREENS (TRASH RACKS) WITH THE FOLLOWING CHARACTERISTICS SHOULD BE PROVIDED TO COVER EACH ORIFICE OUTLET:
 - FOR ORIFICES UP TO 150mm DIA. A FINE APERTURE-EXPANDED METAL MESH SCREEN WITH A MINIMUM AREA OF 50 TIMES THE AREA OF THE ORIFICE, FOR LARGER DIA. ORIFICES, A COARSER GRID MESH WITH A MINIMUM AREA OF 20 TIMES THE ORIFICE AREA MAY BE USED AS AN ALTERNATIVE.
 - STEEL SCREENS SHOULD BE STAINLESS STEEL OR HOT-DIP GALVANIZED
 - WHERE APERTURE-EXPANDED MESH SCREENS ARE EMPLOYED, THEY SHOULD BE POSITIONED SO THAT THE OVAL-SHAPED HOLES ARE HORIZONTAL, WITH THE PROTRUDING LIP ANGLED UPWARDS AND FACING DOWNSTREAM. A HANDLE MAY BE FITTED TO ENSURE CORRECT ORIENTATION AND EASY REMOVAL FOR MAINTENANCE.
 - SCREENS SHOULD BE PLACED NO FLATTER THAN 45 DEGREES TO THE HORIZONTAL IN SHALLOW STORAGE'S UP TO 600mm DEEP. IN DEEPER OR MORE REMOTE LOCATIONS, THE MINIMUM ANGLE SHOULD BE 60 DEGREES TO THE HORIZONTAL.
- IF THE BELOW GROUND OSD STORAGE IS SEALED, A VENT SHOULD BE PROVIDED TO EXPEL ANY NOXIOUS GASES (AS3500.3 CLAUSE 7.10.2.D.B).
- THE STORAGE SHOULD BE DESIGNED TO FILL WITHOUT CAUSING OVERFLOWS IN UPSTREAM CONDUITS DUE TO BACKWATER EFFECTS (AS3500.3 CLAUSE 7.10.2.D.C).
- BELOW GROUND STORAGE'S SHALL BE CONSTRUCTED OF CONCRETE, MASONRY, ALUMINUMIZING AND ALUMINIUM ALLOY COATED STEEL, ZINC-COATED STEEL, GALVANISED IRON OR PLASTICS (AS3500.3 7.10.3).

MAINTENANCE SCHEDULE: ON SITE DETENTION (OSD)

ALL OSD MAINTENANCE TASKS SHOULD BE UNDERTAKEN AFTER A SIGNIFICANT STORM EVENT

6 MONTHLY

ELEMENT	TASK	DESCRIPTION / ACTION
ORIFICE PLATE	INSPECT FOR BLOCKAGE	CHECK PLATE FOR BLOCKAGE AND CLEAN
TRASH SCREEN	CHECK / CLEAN	CHECK AND CLEAN TRASH SCREEN
PIT SUMP	CHECK FOR SEDIMENT	CHECK FOR SEDIMENT / LITTER / SLUDGE AND CLEAN-OUT
GRATED LIDS	CHECK FOR DAMAGE	CHECK FOR CORROSION OR OTHER DAMAGE AND REPAIR / REPLACE AS NEEDED
	CLEAR BLOCKAGES	CHECK AND CLEAR BLOCKAGES
STORAGE LIDS	CHECK	REMOVE DEBRIS / MULCH / LITTER / SEDIMENT
OUTLET PIPES	CHECK FOR BLOCKAGES	CHECK / CLEAN / FLUSH OUTLET PIPES, REMOVE ANY BLOCKAGES
STEP IRONS	CHECK FIXING	ENSURE STEP-IRON FIXINGS ARE SECURE AND REPAIR AS NEEDED

ANNUALLY

ELEMENT	TASK	DESCRIPTION / ACTION
ORIFICE PLATE	CHECK ATTACHMENT	ENSURE PLATE IS MOUNTED SECURELY, TIGHTEN AND SEAL GAPS AS REQUIRED
TRASH SCREEN	CHECK ATTACHMENT	ENSURE PLATE IS MOUNTED SECURELY, TIGHTEN AND SEAL GAPS AS REQUIRED
	CHECK CORROSION	CHECK TRASH SCREEN FOR CORROSION, ESPECIALLY AT CORNERS NEAR WELDS AND REPAIR / REPLACE AS NEEDED
STEP IRONS	CHECK FOR CORROSION	EXAMINE STEP IRONS AND REPAIR ANY DAMAGE
INTERNAL WALLS	CHECK	CHECK FOR CRACKS / SPALLING AND REPAIR AS NEEDED
OSD SURROUNDS	CHECK FOR SUBSIDENCE	CHECK FOR SUBSIDENCE WHICH MAY INDICATE LEAKS) AND REPAIR AS NEEDED

5-YEARLY

ELEMENT	TASK	DESCRIPTION / ACTION
ORIFICE PLATE	CHECK ORIFICE PLATE	CHECK ORIFICE SIZE AGAINST WAE AND CHECK FOR FITTING / SCARRING, REPLACE IF NECESSARY

COLOUR LEGEND

NEW (REFER TO SCHEDULES FOR COLOUR DEFINITION)
EXISTING
REMOVED OR RELOCATED

GREENVIEW CIVIL SHEET LIST		
No.	SHEET NAME	REV.
C01	NOTES & LEGENDS	6
C02	GROUND FLOOR DRAINAGE PLAN	6
C03	SITE STORMWATER DETAILS SHEET 1	4
C04	SITE STORMWATER DETAILS SHEET 2	4
C05	MUSIC MODEL SHEET	1

RECOMMENDED SAFETY SIGNS



CONFINED SPACE DANGER SIGN

- A CONFINED SPACE DANGER SIGN SHALL BE POSITIONED IN A LOCATION AT ALL ACCESS POINTS, SUCH THAT IT IS CLEARLY VISIBLE TO PERSONS PROPOSING TO ENTER THE BELOW GROUND TANKS CONFINED SPACE.
 - MINIMUM DIMENSIONS OF THE SIGN
 - 300mm x 450mm (LARGE ENTRIES, SUCH AS DOORS)
 - 250mm x 180mm (SMALL ENTRIES SUCH AS GRATES & MANHOLES)
- THE SIGN SHALL BE MANUFACTURED FROM COLOUR BONDED ALUMINUM OR POLYPROPYLENE
- SIGN SHALL BE AFFIXED USING SCREWS AT EACH CORNER OF THE SIGN.

EXISTING SERVICES



ABBREVIATIONS

DP	DOWN PIPE
FFL	PROPOSED FINISHED FLOOR LEVEL
GL	PROPOSED PIT SURFACE LEVEL
IL	PROPOSED PIT INVERT LEVEL
IO	INSPECTION OPENING
K&G	KERB & GUTTER
K&P	FINISHED PAVEMENT LEVEL
RCP	REINFORCED CONCRETE PIPE
R&G	ROLL ROLLER GUTTER
RL	FINISHED SURFACE LEVEL
RWO	RAINWATER DRAINAGE OUTLET
RWT	PROPOSED RAINWATER TANK
TK	TOP OF NEW KERB LEVEL
TWV	TOP OF WATER LEVEL
UPVC	RIGID PVC PIPE
VD	VERTICAL DROPPER

CONFIRM BALCONIES DO NOT HAVE HOB AT EDGE. IF THERE IS A HOB, PROVIDE OUTLETS AS REQUIRED AND MIN 2 x 200W x 100H OVERFLOWS. TYPICAL.

BALCONIES TO FALL AWAY FROM BUILDING AT MIN 2%. TYPICAL

GREENVIEW NOTES 30mm STEP AT THRESHOLD FROM INTERNAL FFL TO BALCONY RL. TYPICAL

PROVIDE 100W GRATED DRAIN AT BALCONY AND DESK THRESHOLDS. TYPICAL

PROPOSED SUBSTATION

GREENVIEW NOTES >150mm STEP FROM INTERNAL FFL TO LANDSCAPE LEVELS. TYPICAL

GREENVIEW NOTES 30mm THRESHOLD RAMP FROM INTERNAL LOBBY FFL TO ENTRY RL.

LOBBY ENTRIES TO FALL AWAY FROM BUILDING AT MIN 2%. TYPICAL

GREENVIEW RECOMMENDS MIN 150mm STEP FROM INTERNAL FFL TO EXTERNAL LANDSCAPE RL

GREENVIEW NOTES 30mm STEP FROM ALL INTERNAL UNIT FFL'S TO EXTERNAL BALCONY/PATIO LEVEL. TYPICAL.

GREENVIEW RECOMMENDS MIN 50mm STEP FROM INTERNAL FFL TO EXTERNAL RL

OFFLINE JELLYFISH UNIT
JF-900-2-1-PIT-OFF-460
INLET IL +14.10
OUTLET IL +14.10
WEIR RL +14.56 [BELOW OSD OUTLET THEREFORE OK]

EXISTING COUNCIL STORMWATER PIPE.
APPROX Ø900mm
OSD OUTLET IL TO BE AT PIPE OBVERT TO MITIGATE BACKFLOW

EXISTING KERB INLET PIT
GL +15.25
IL +13.92 APPROX
CONNECTION IL +14.04
STW OL +14.82 APPROX

ALL ROOF WATER TO RAINWATER TANK/OSD TANK PER BASIX REQUIREMENTS. DESIGN BASED ON GROUND FLOOR FFL +16.350

ALL ROOF WATER TO RAINWATER TANK/OSD TANK PER BASIX REQUIREMENTS. DESIGN BASED ON GROUND FLOOR FFL +16.350

RAINWATER TANK
LOCATION CAN VARY. BELOW GROUND RWT WILL LIMIT OSD TWL
MIN VOLUME 10kL UNLESS LARGER VOLUME REQUIRED FOR BASIX. REUSE FOR IRRIGATION UNLESS ADDITIONAL REUSE REQUIRED PER BASIX
MIN GL +15.610
TWL +15.310
(OSD TWL LIMITED TO 15.210 DUE TO RWT BELOW GROUND)

BELOW GROUND OSD TANK
APPROX 20m³ OF OSD REQUIRED
MIN GL +15.610
MIN IL +14.82 (ABOVE OBVERT OF COUNCIL STORMWATER PIPE, ASSUMING Ø900mm PIPE)
MAX IL +14.900
AV IL +14.860
MIN INTERNAL HEIGHT = 510mm > 500mm RESIDENTIAL MINIMUM
MAX WATER DEPTH = 390mm
AV WATER DEPTH = 320mm
5y VOLUME REQUIRED = 9.7m³
5y PLAN AREA = 64m²
5y AV WATER DEPTH = 156mm
5y TWL +15.016
5y VOLUME ACHIEVED = 9.98m³ [OK]
100y VOLUME REQUIRED = 17.0m³
100y PLAN AREA = 65m²
100y AV WATER DEPTH = 320mm
100y TWL +15.210
100y VOLUME ACHIEVED = 20.8m³ [OK]

GREENVIEW NOTES 30mm THRESHOLD RAMP FROM INTERNAL LOBBY FFL TO ENTRY RL.

GROUND BELOW BUILDING TO BE CUT PER FLOODING REQUIREMENTS. REFER FLOOD REPORT BY GREENVIEW CONSULTING.

GROUND FLOOR DRAINAGE PLAN

Scale: 1 : 150

1. ALL NEW WORKS SHALL MAKE A SMOOTH JUNCTION WITH EXISTING.
2. THE BUILDER/CONTRACTOR SHALL LOCATE ALL EXISTING PUBLIC UTILITY SERVICES WITHIN THE SITE. FOOTPATH AREA AND ROAD RESERVE PRIOR TO THE COMMENCEMENT OF ANY WORKS. ALL LOCATIONS AND LEVELS OF SERVICES SHALL BE REPORTED TO THE STORMWATER ENGINEER PRIOR TO THE COMMENCEMENT OF ANY WORKS TO ENSURE THERE ARE NO OBSTRUCTIONS IN THE LINE OF THE DRAINAGE DISCHARGE PIPES.
3. PRIOR TO COMMENCING ANY WORKS ON THE SITE, THE BUILDER SHALL ENSURE THAT THE INVERT LEVELS OF WHERE THE SITE STORMWATER SYSTEM CONNECTION INTO COUNCIL'S KERB/DRAINAGE SYSTEM MATCH THE DESIGN LEVELS. ANY DISCREPANCIES SHALL BE REPORTED TO THE DESIGN ENGINEER IMMEDIATELY
4. ALL STORMWATER DRAINAGE WORK TO AVOID TREE ROOTS. WHERE NOT POSSIBLE, ALL EXCAVATIONS IN VICINITY OF TREE ROOTS ARE TO BE HAND DUG.
5. ALL BASES OF PITS TO BE BENCHED (TO HALF PIPE DEPTH) TO THE INVERT OF THE OUTLET PIPE WITH ALL PIPES CUT FLUSH WITH SIDE OF PIT. TO ALLOW SMOOTH FLOW OF STORMWATER
6. PROVIDE GALVANISED ANGLE SURROUNDINGS TO GRATE WHERE IN TRAFFICABLE AREAS.
7. PROVIDE 100mm GAP IN BASE OF FENCE FOR EMERGENCY OVERFLOWS.
8. PROVIDE SUBSOIL DRAINAGE AND OUTLETS TO ALL ON PODIUM PLANTER BOXES. OUTLET PIPES NOT SHOWN FOR CLARITY OF DOCUMENTATION.
9. ALL DOWNPIPES ARE TO BE PIPE CONNECTED INTO THE FORMAL RAINWATER OR STORMWATER LINE UNLESS SPECIFICALLY NOTED ON THE DRAWINGS OTHERWISE.
10. ALL PIPES TO BE 100mmØ @ 1% MINIMUM UNLESS NOTED OTHERWISE.
11. ALL BASES OF PITS TO BE BENCHED TO THE INVERT OF THE OUTLET PIPE WITH ALL PIPES CUT FLUSH WITH SIDE OF PIT. TO ALLOW SMOOTH FLOW OF STORMWATER.
12. PROVIDE GALVANISED ANGLE SURROUNDINGS TO GRATES IN TRAFFICABLE AREAS.

NOTE: PROVIDE SUBSOIL DRAINAGE TO ALL RETAINING WALLS AND CONNECT TO STORMWATER SYSTEM. PIPES NOT SHOWN FOR CLARITY. TYPICAL.

NOTE: SITE IS WITHIN THE 1% AEP FLOOD ZONE. REFER FLOOD REPORT BY GREENVIEW CONSULTING.

GENERAL LEGEND

LANDSCAPE
HARDSTAND
ROOF AREA TO DRAIN
OSD

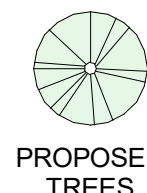

PROPOSED TREES



EXISTING TREES

CIV - FIXTURES SCHEDULE		
	TYPE	DESCRIPTION
		GRATED STORMWATER PIT
		PERIMETER STRIP DRAIN
		SEALED STORMWATER PIT
	300W	GRATED STRIP DRAIN

CIV - STANDARD SYMBOLS	
	DESCRIPTION
	FALL ARROW
	OVERLAND FLOW PATH

CIV - STORMWATER SERVICES		
	TYPE	DESCRIPTION
	STW	STORMWATER
	STW EX	EXISTING STORMWATER

Wollongong OSD Method

CATCHMENT DATA		
Subarea name:	Site	
Total site area:	2479	
Pre-development impervious%:	22	
Postdevelopment impervious%:	65	
Extra Catchment:	0	
Extra catch impervious%	0	
Intensity 50yr 1hr	104	
Total tributary area:	2479	
Tributary pre-dev imp%:	22.0	
Tributary post-dev imp%:	65.0	
GRAPH DATA		
F1-5yr	1.08	
F1-100yr	1.06	
F2	1.09	
F3-pre	0.06	
F3-post	0.15	
F4	0.71	
OSD CALCULATIONS		
Pre-dev SSR-5yr	7.0	
Pre-dev SSR-100yr	12.2	
PSD-5yr	75.1	
PSD-100yr	131.4	
SSR-5yr	16.7	
SSR-100yr	29.2	
Final PSD-5yr	80.8	
Final PSD-100yr	139.1	
Final SSR-5yr	9.7	
Final SSR-100yr	17.0	
Orifice and Weir		
Depth of water from TWL-5yr to CL	0.156	
Weir height	0.32	
Suggested orifice diameter:	313	
Suggested weir length:	0.20	

WSUD CALCULATIONS:
SITE INCLUDES 21 UNITS > 20 UNITS IN MULTI-DWELLING, THEREFORE WSUD MODELLING IS REQUIRED. REFER C05 FOR MUSIC MODEL DETAILS

PROPOSED WSUD DESIGN:
MIN 10kL RAINWATER TANK REQUIRED WITH IRRIGATION REUSE.
ALL DRIVEWAY AND PARKING AREA TO BE TREATED THROUGH OCEANGUARDS BEFORE OSD.
END OF LINE OFFLINE JELLYFISH UNIT TO BE PROVIDED JF900-2-1 WITH 460mm WEIR

MODELLING DETAILS BELOW:
-MUSIC VERSION 6.3.0
-RAINFALL STATION 068131 PORT KEMBLA. 6 MINUTE TIME STEP FROM 1970 TO 1979
-NSW MUSIC MODELLING GUIDELINES. AUGUST 2015 UTILIZING MODIFIED % IMPERVIOUS AREA, RAINFALL THRESHOLD, SOIL PROPERTIES & POLLUTANT CONCENTRATION.
-NO DRAINAGE ROUTING BETWEEN NODES.
-80% TOTAL SUSPENDED SOLIDS REDUCTION
-55% TOTAL PHOSPHORUS REDUCTION
-40% TOTAL NITROGEN REDUCTION
-90% GROSS POLLUTANTS



LEVEL 15, 12 DARCY ST
PARRAMATTA NSW 2150
PHONE No (02) 9354 1836

www.nsw.gov.au/homes-nsw



REV.	DATE	BY	DESCRIPTION
8	06.06.2025	JPS	STAGE C ISSUE
7	23.05.2025	JAB	STAGE C ISSUE
6	24.02.2025	JPS	STAGE C ISSUE
5	18.11.2024	JPS	STAGE C ISSUE
4	21.10.2024	JPS	STAGE C ISSUE
3	11.10.2024	JPS	STAGE C DRAFT
2	23.08.2024	JPS	STAGE B ISSUE
1	26.09.2024	JPS	PRELIMINARY ISSUE

The copyright of this document & design remains with Greenview Consulting Pty Ltd and shall not be reproduced without prior consent

ARCHITECT	STRUCTURAL CONSULTANT
PROJECT MANAGER	HYDRAULIC CONSULTANT
LAND & HOUSING CORPORATION	LANDSCAPE CONSULTANT
ELECTRICAL CONSULTANT	
GREENVIEW CONSULTING Pty Ltd	

STRUCTURAL CONSULTANT	BUSINESS PARTNER
GREENVIEW CONSULTING Pty Ltd	
HYDRAULIC CONSULTANT	
GREENVIEW CONSULTING Pty Ltd	
LANDSCAPE CONSULTANT	



PROJECT:	TITLE:
PROPOSED DEVELOPMENT	GROUND FLOOR DRAINAGE PLAN
AT	
5-9 Alexander Street, Fairy Meadow, NSW	

TITLE:	
GROUND FLOOR	
DRAINAGE PLAN	

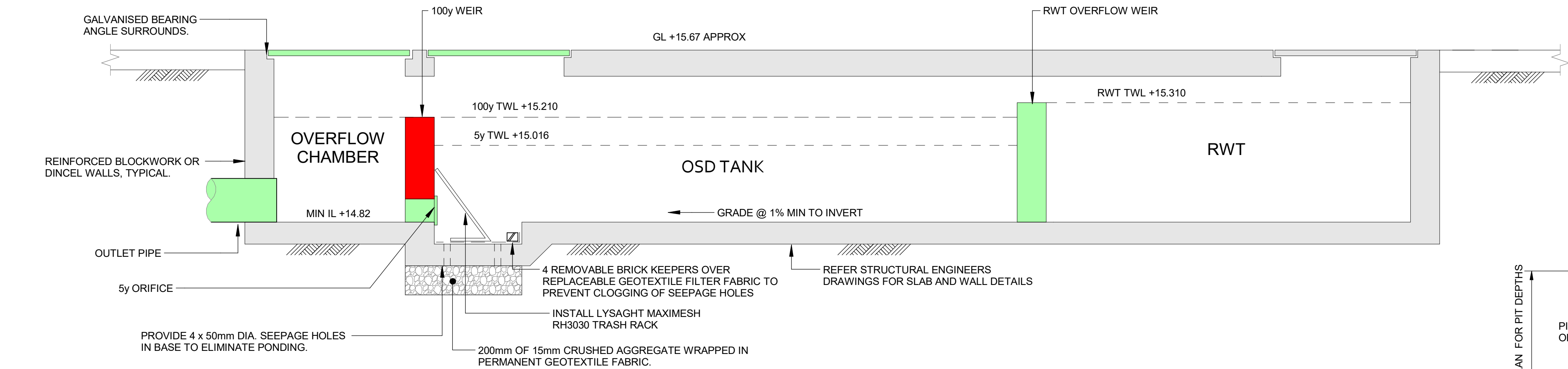

1 OSD SECTION 1
Scale: 1 : 20

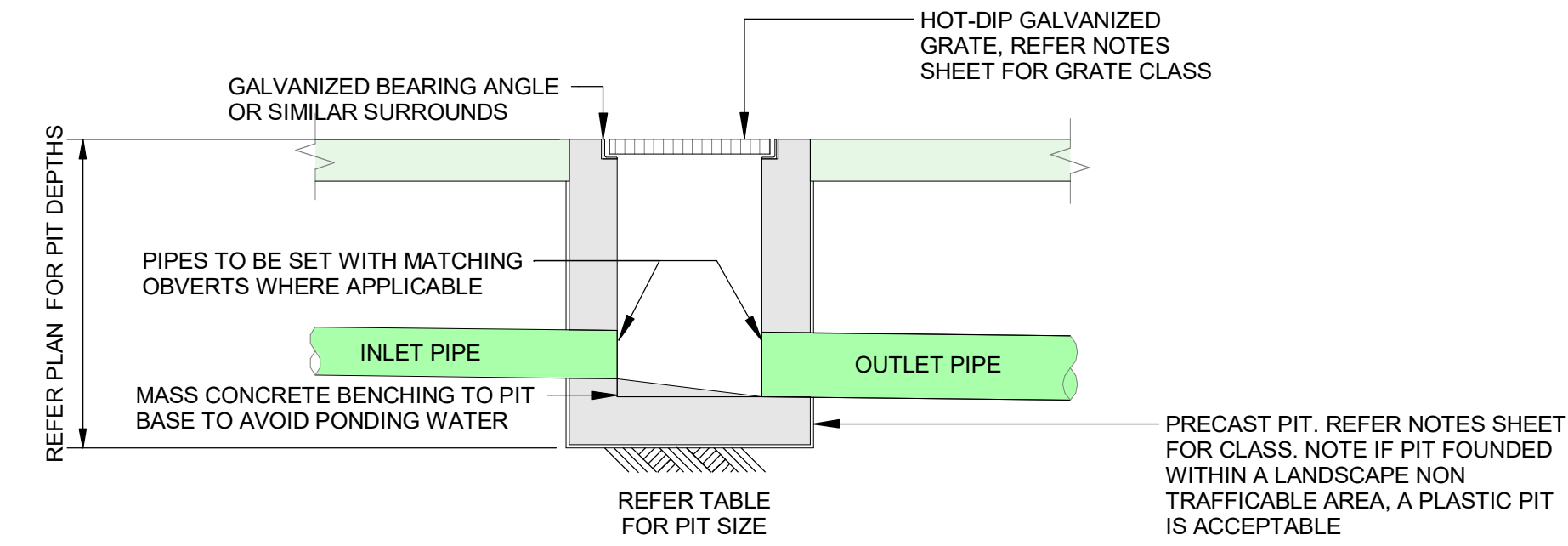

1. ENSURE CLIMB IRONS ARE PROVIDED UNDER LID AT 300 CTS TO COUNCIL'S SPECIFICATIONS WHERE PIT DEPTH IS DEEPER THAN 1000.
2. GREENVIEW RECOMMENDS THE PLUMBER PROVIDES 90Dia x 3000 LONG SUBSOIL DRAINAGE STUB PIPE SURROUNDED WITH 100mm THICKNESS OF NOMINAL 20mm COARSE FILTER MATERIAL WRAPPED IN GEOTEXTILE FILTER FABRIC. (BIDUM A24 OR APPROVED SIMILAR), TO BE PARALLEL TO UPSTREAM SIDE OF EACH INLET PIPE.

PIT SIZE	DEPTH	PIT DIMENSION
	0 - 600	450 mm x 450 mm
	600 - 900	600 mm x 600 mm
	900 - 1200	600 mm x 900 mm
	1200 +	900 mm x 900 mm

TYPICAL CONCRETE INLET PIT - LANDSCAPE SURFACE
Scale: 1 : 20

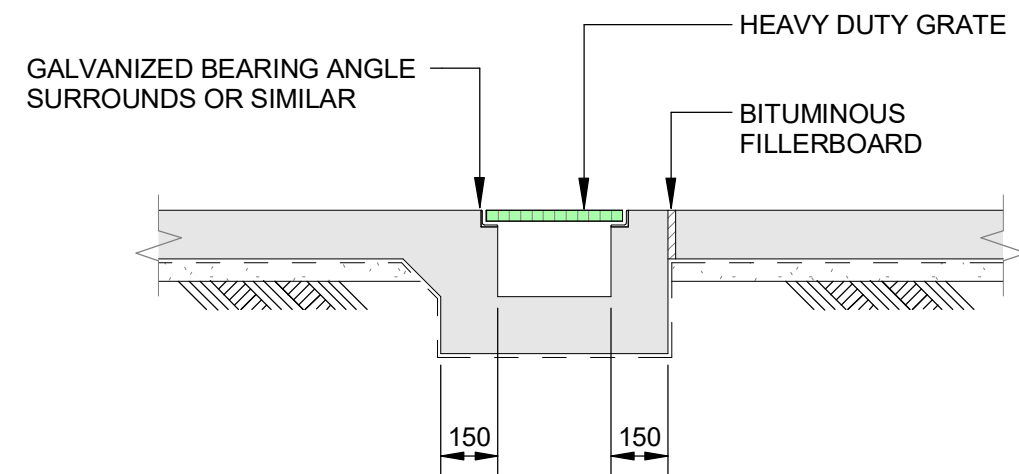

TYPICAL GRATED DRAIN DETAIL
Scale: 1 : 20

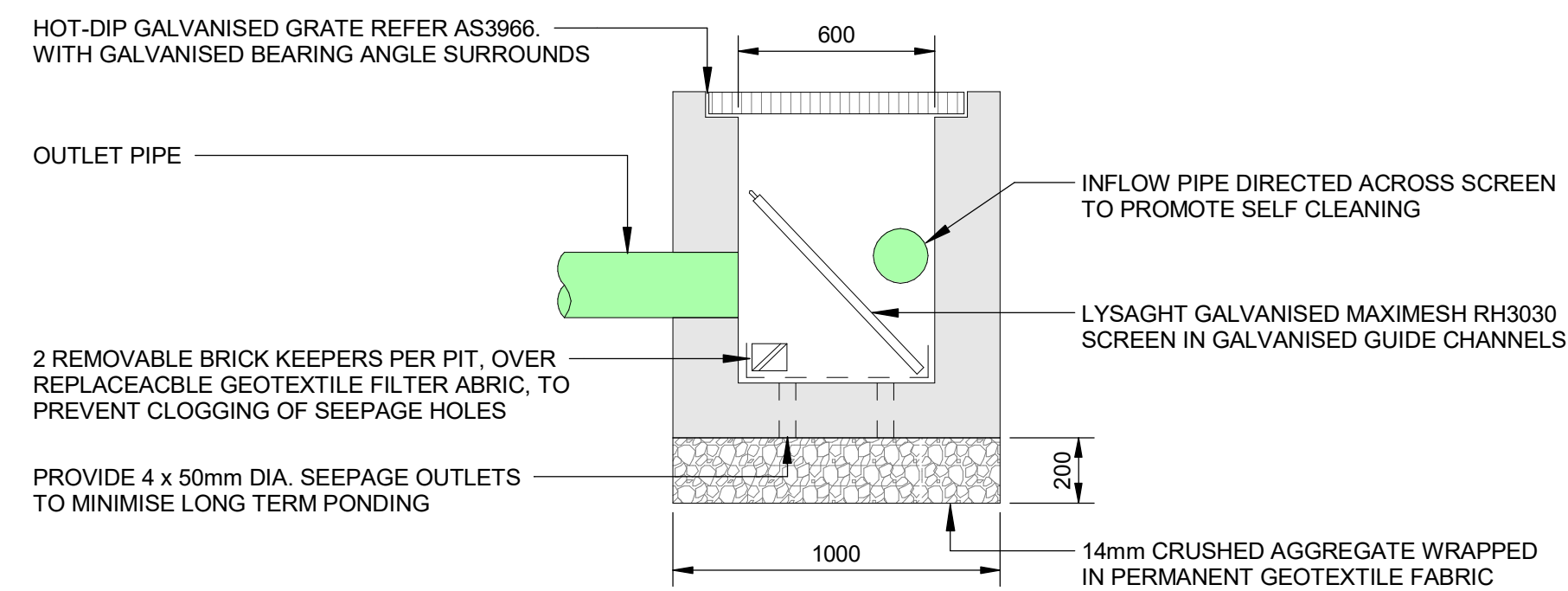

MAINTENANCE OF SILT ARRESTOR PIT IS TO BE CARRIED OUT AT LEAST EVERY SIX MONTHS AND AFTER EVERY SIGNIFICANT STORM EVENT

SILT ARRESTOR PIT
Scale: 1 : 20

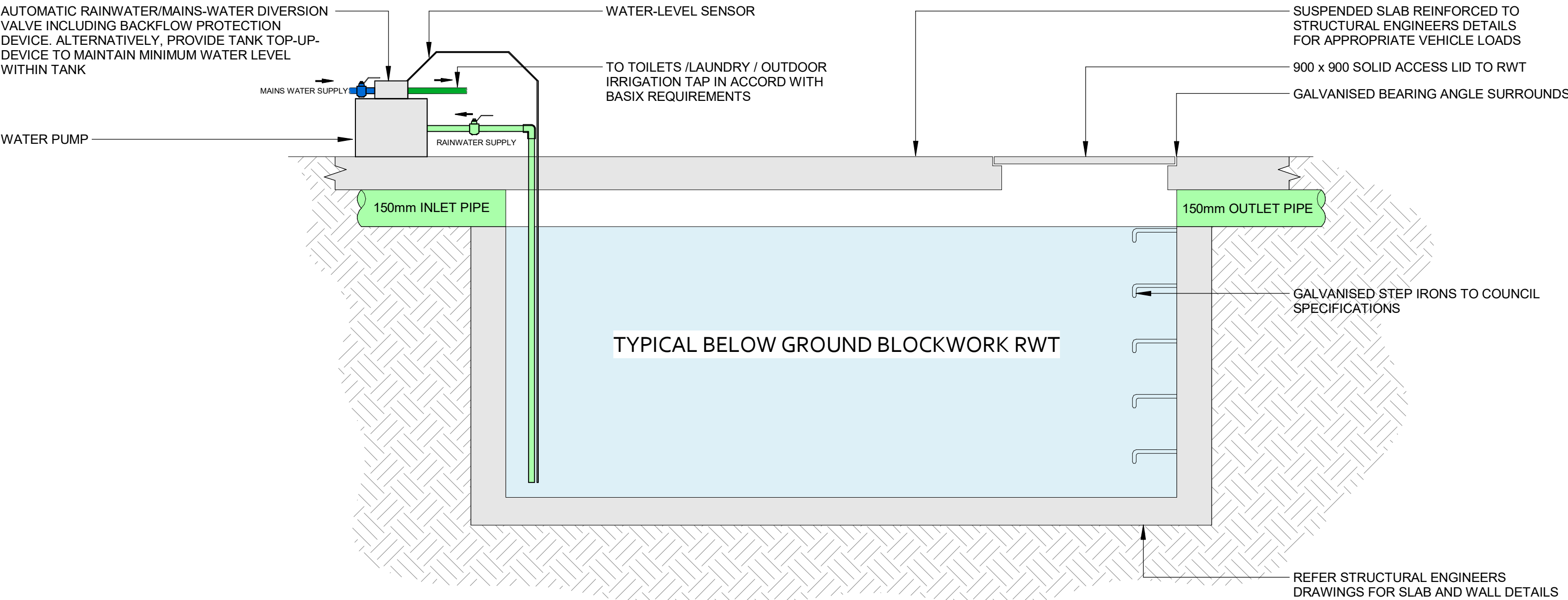

1. PROVIDE DIVERSION DEVICE AS SHOWN TO ENSURE MAINS-WATER SWITCH-OVER OCCURS ONCE WATER LEVEL IN TANK REACHES THE MINIMUM LEVEL. ALTERNATIVELY, A TOP-UP DEVICE (OR AIR-BREAK SYSTEM) MAY BE EMPLOYED TO ENSURE THE MINIMUM AFTER LEVEL IN THE TANK IS MAINTAINED.
2. RAINWATER FIXTURES, INFLOW AND OUTFLOW PIPES TO AS3500.1 (2003).
3. ANY CONTAINMENT/BACKFLOW PREVENTION DEVICE TO BE IN ACCORD WITH THE LOCAL WATER AUTHORITY.
4. RAINWATER USAGE AND MINIMUM VOLUMES TO BASIX OR AS SPECIFIED BY THE STORMWATER ENGINEER.
5. ALL PIPING SYSTEMS DELIVERING RAINWATER TO TAPS, FIXTURES, OUTLETS OR APPLIANCES MUST BE INSTALLED BY A LICENSED PLUMBER.

TYPICAL CAST INSITU (BELOW GROUND) RAINWATER TANK

Scale: 1 : 20

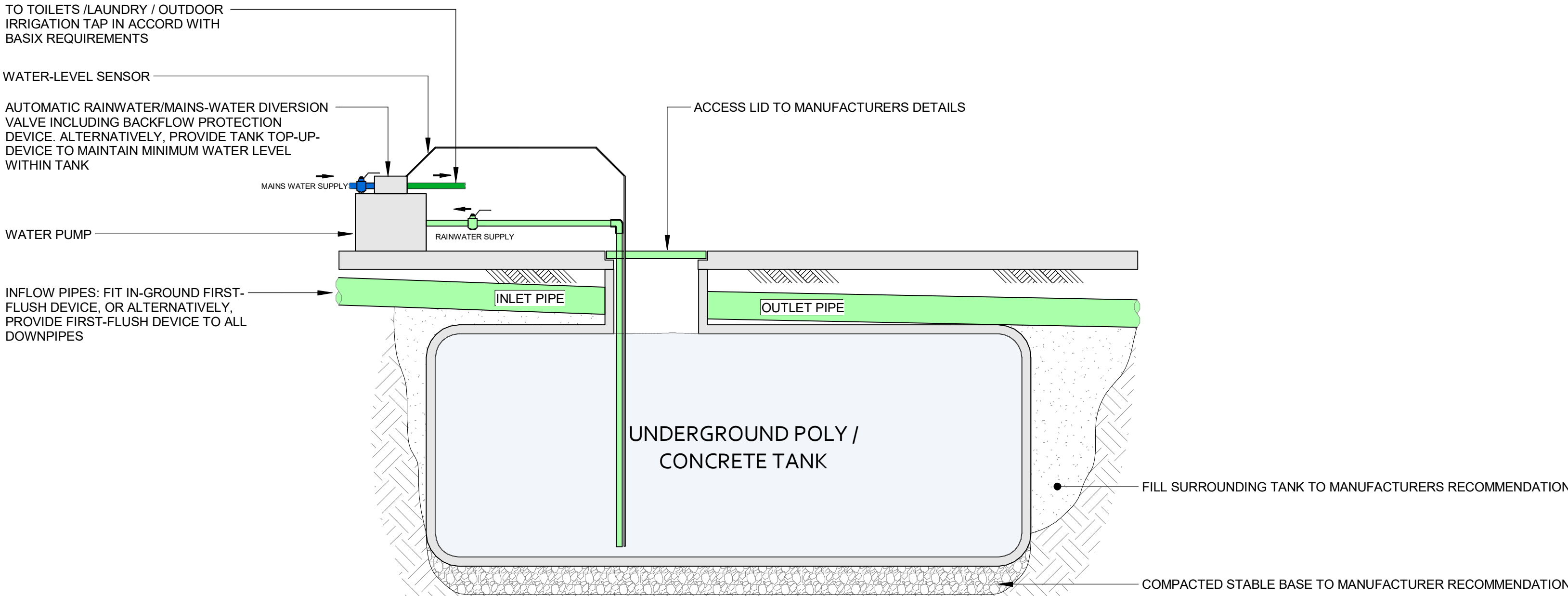

1. PROVIDE DIVERSION DEVICE AS SHOWN TO ENSURE MAINS-WATER SWITCH-OVER OCCURS ONCE WATER LEVEL IN TANK REACHES THE MINIMUM LEVEL. ALTERNATIVELY, A TOP-UP DEVICE (OR AIR-BREAK SYSTEM) MAY BE EMPLOYED TO ENSURE THE MINIMUM AFTER LEVEL IN THE TANK IS MAINTAINED.
2. RAINWATER FIXTURES, INFLOW AND OUTFLOW PIPES TO AS3500.1 (2003).
3. ANY CONTAINMENT/BACKFLOW PREVENTION DEVICE TO BE IN ACCORD WITH THE LOCAL WATER AUTHORITY.
4. RAINWATER USAGE AND MINIMUM VOLUMES TO BASIX OR AS SPECIFIED BY THE STORMWATER ENGINEER.
5. ALL PIPING SYSTEMS DELIVERING RAINWATER TO TAPS, FIXTURES, OUTLETS OR APPLIANCES MUST BE INSTALLED BY A LICENSED PLUMBER.

TYPICAL BELOW GROUND RAINWATER TANK

Scale: 1 : 20

